

Locksmith & Unlock Cable

Installation Instructions



*for 2020+ Chevrolet Silverado HD & GMC Sierra HD
with 6.6L Duramax L5P engine*

▲WARNING: *Failure to follow the ECM and TCM Unlock Cable instructions in the proper order may result in damage to the vehicle, device, and included hardware. Please refer to all included instructions.*

E41 ECM Unlock Cable Instructions

For ECM Unlock

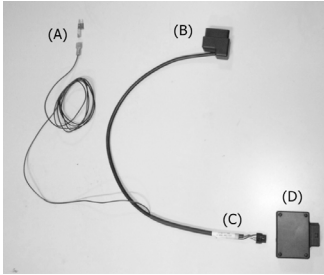

Unlock Cable Part Reference

- (A) 2-Blade Fuse Plug
- (B) Unlock Cable OBD Plug
- (C) Unlock Cable
- (D) Locksmith Unlock Module

NOTE: Your cable also includes a 3-Blade Fuse Plug. This is not used for this vehicle application. Only use the 2-Blade fuse for this install.

For your vehicle to accept tuning, you must perform a one-time unlock process on the Engine Control Module. With this Unlock Cable kit, you are able to unlock your own ECM using your tuning device without having to remove the ECM from the vehicle or ship it to us. Once the unlock is completed, you do not need to use the cable to install tunes or modify options. For 2020+ trucks, you must unlock both the Engine and Transmission to tune the vehicle.

Do not drive your vehicle with the Unlock Cable in place!



STEP 1 - Before installing the Unlock Cable, make sure you have plugged your tuning device into the vehicle, attempted to tune, and then updated your device from Update Agent!

STEP 2 - Go to your vehicle. Open the hood and locate the engine bay fusebox. Press the two tabs indicated by the arrows and lift on the fusebox lid to remove the lid.

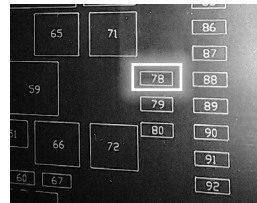

E41 ECM Unlock Cable Instructions Cont'd

STEP 3 - Locate fuse number "78" (ECM) as indicated on the fuse box lid diagram, and remove it. Do not lose this fuse as you must replace it in this spot later.

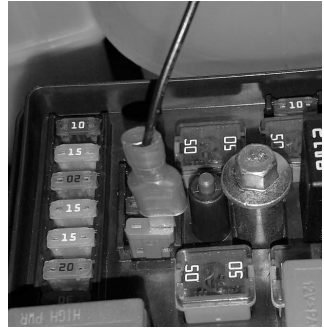

STEP 4 - Connect the included 2-Blade Fuse Plug (A) to the Unlock Cable and plug the Fuse Plug into the slot you pulled the original fuse from. Ensure that you orient the Fuse Plug so that the wire is coming out on the side closest to the driver side of the vehicle, and furthest from the passenger side.



STEP 5 - Route the Unlock Cable out of the engine bay, around the driver side A-Pillar, and through the open window.

STEP 6 - Plug the Unlock Cable OBD Plug (B) into your vehicle's OBD Port.



STEP 7 - Plug the Unlock Cable (C) into the Locksmith module (D).

STEP 8 - Plug your tuning device's OBD Plug (E) into the Locksmith module (D). Make sure it is plugged in all the way, as it is a tight fit. Turn on your vehicle's ignition.

E41 ECM Unlock Cable Instructions Cont'd

STEP 9 - Your tuning device should now power up. Select 'Tune' and follow the on-screen instructions to unlock your vehicle and enable tuning. Once your vehicle has been unlocked, you are finished with the Unlock Cable, and you will not need to use the cable to install a tune. Remove the Unlock Cable when directed by the device.

UNLOCK CABLE REMOVAL - Turn off your vehicle's ignition. Disconnect the Unlock Cable OBD Plug (B) from the vehicle's OBD Port. Then, you may remove the Fuse Plug (A) from the vehicle's fusebox. Place the vehicle's original fuse back into its slot and put the fusebox lid back on.

You have now completed the Engine Unlock and may proceed to the **T93 Transmission Unlock Cable Instructions** (pg 4). *Once both the Engine and Transmission are unlocked, you may tune the vehicle.*

▲WARNING: *Failure to follow the ECM and TCM Unlock Cable instructions in the proper order may result in damage to the vehicle, device, and included hardware. Please refer to all included instructions.*

T93 Transmission Unlock Cable Instructions

For Transmission Unlock

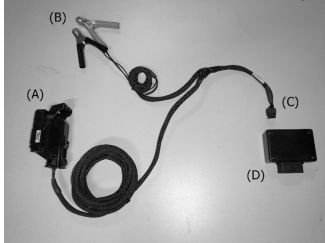

Unlock Cable Part Reference

- (A) TCM Connector
- (B) Battery Clips
- (C) Unlock Cable
- (D) Locksmith Unlock Module

For your vehicle to accept tuning, you must perform a one-time unlock process on the T93 Transmission Control Module. With this Unlock Cable kit, you are able to unlock your own TCM using your tuning device without having to remove the TCM from the vehicle or ship it to us. Once the unlock is completed, you do not need to use the cable to install tunes or modify options.

Do not drive your vehicle with the Unlock Cable in place!

STEP 1 - Before installing the Unlock



Cable, make sure you have unlocked your ECM by following all steps in the previous section: ***E41 ECM Unlock Cable Instructions.***



STEP 2 - Open your vehicles hood and locate the indicated Relay Box. This is on the driver side of the engine bay, next to the radiator. Press the indicated tab and slide up the Relay Box to unmount it, and set it aside for now. This will expose the T93 Transmission Control Module (E).

T93 Transmission Unlock Cable Instructions Cont'd

STEP 3 - Now you must unplug the vehicle connector from the T93 TCM. (**NOTE:** *You will be able to reach it with your hand as it is not very deep inside the engine bay.*) The following steps will be somewhat difficult to see due to the angle, but you can perform them by feel. To unplug the TCM connector, slide out the retention tab (1), then press in the release tab (2) until you feel it click. After that, the locking lever (3) will loosen.

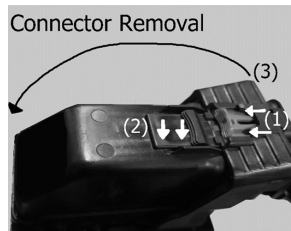

STEP 4 - Open the locking lever (3) all the way and then the connector can be pulled off of the TCM. You can push the TCM connector aside and leave it dangling; it is on a short cable and will not drop further into the engine bay.

STEP 5 - Now you will connect the Unlock Cable

TCM Connector (A) in its place. Feed the TCM Connector (A) into the engine bay from the top, and orient the connector so that the cable is coming up from the TCM (opposite of the vehicle connector, which has the cables coming down from the TCM). Press the connector into the TCM port, then close its locking lever (3) until you hear a click.

STEP 6 - Route the rest of the Unlock Cable over to the vehicle's battery. Slide open the red (positive) battery terminal cover and clip the red (positive) Alligator Clip (B) from the Unlock Cable into the positive tab inside. Then, clip the black (negative) Alligator Clip (B) onto a nearby Ground stud.

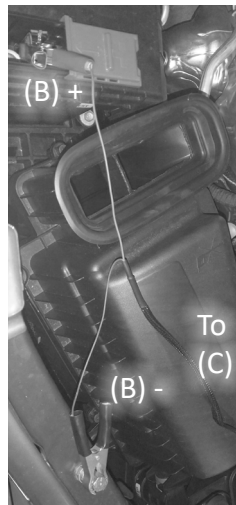

T93 Transmission Unlock Cable Instructions Cont'd

STEP 7 - Plug the Unlock Cable connector (C) into the Locksmith (D). Then, plug your tuning device into the Locksmith's OBD port (D). At this point, your tuning device will power up.

STEP 8 - Select "Tune" and follow the on-screen instructions to unlock your transmission module and enable tuning. Once your transmission has been unlocked, you are finished with the Unlock Cable, and you will not need to use the cable to install a tune. Remove the Unlock Cable when directed by the device.

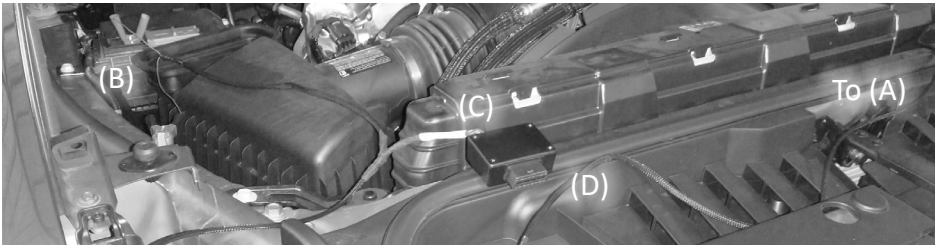

UNLOCK CABLE REMOVAL - Disconnect your tuning device from the Locksmith (D) and the Locksmith from the Unlock Cable (C). Now, unclip the Alligator Clips (B) from the battery terminals. Close the red battery cover. Disconnect the Unlock Cable TCM Connector (A) using the same steps as Step 3. Find the original vehicle transmission connector hanging nearby and reconnect it to the TCM by pressing the connector into the TCM port, and closing the locking lever (3) until you hear a click. Slide the retention tab (1) back in to secure the connector. Now, take the Relay Box from Step 2 and slide it back onto its mounting tab until it clicks into place.

If you have already completed the Engine Unlock, you may now connect your tuning device into your vehicle's OBDII port and start tuning!

Page Intentionally Left Blank

Page Intentionally Left Blank

For additional questions not found in the user guide, call:

Holley Technical Support: (888)-360-3343

Mon - Fri 8:00 am - 5:00 pm MST, Sat 8:00 am - 2:00 pm MST

To expedite your support call, please have your Vehicle Information, Part Number, and Serial Number ready prior to calling Technical Support.

Holley[®]
TUNING GROUP

© Copyright 2023 Holley Inc. and subsidiaries. All rights reserved.

D10029200 Rev01 02/07/2023