



Gauge Mounting Arm Installation Instructions

2015-2019 GM 2500/3500

2019-2022 GM 1500

2020-2022 GM 2500/3500

Materials

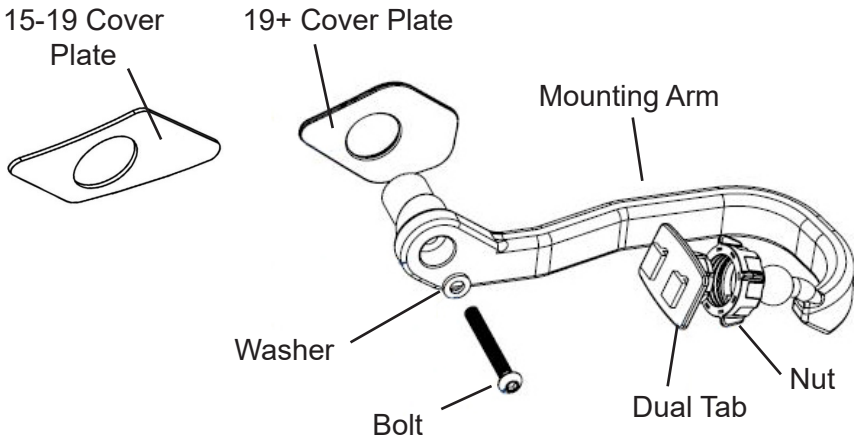

Required Tools

- 10 mm 1/4" drive Socket, deep or regular
- 3 1/4" Drive Extension
- 1/4" Drive Socket Wrench
- Small 1/7" Flat-blade Screwdriver
- 4 mm Allen Wrench

Mounting Arm Installation

1. On the driver's side A-pillar grab handle, carefully remove the lower cover by prying it loose using a screwdriver.
2. Remove the exposed bolt. Keep the cover and bolt should you wish to return the vehicle to stock.
3. Using the hardware included with the mounting arm, install the flat washer on the bolt and insert the bolt through the mounting arm.
4. Place the cover plate onto the mounting arm so that the curve in the cover will line up with the A-pillar once installed.
5. Orient the cover so that the profile matches the recess of the A-pillar.

Mounting Arm Installation Cont'd

6. Insert the mounting arm and cover into the hole and loosely thread the bolt into the hole just tight enough that it won't fall out.
7. If your cover has an adhesive back attached, remove the cover paper and position the cover in place by pressing it into the recess.
8. Use the Allen wrench to tighten the arm to the pillar while trapping the cover in place against the A-pillar. The arm can be positioned in the desired position by loosening or tightening the bolt.
9. Remove the dual tab from the bag. If the dual tab and nut are screwed together, unscrew them slightly from one another until the nut moves freely.
10. Snap the nut and dual tab over the ball on the mounting arm and tighten the nut (if the nut won't go onto the ball, the tab and nut may need to be unscrewed further).
11. Attach your device to the dual tab and secure the cord. Adjust the device position using the mounting bolt and/or dual tab/nut.



Before Installation



After Installation

Copyright© 2021

D10026300 Rev03 02/01/2022

For additional questions not found in the user guide call:

Powerteq Technical Support: (801)-476-3343 6:00 am - 5:00 pm MST

**To expedite your support call, please have your Vehicle Information,
Part Number, and Serial Number ready prior to calling Technical Support.**