

# Jammer CAi

## INSTALL GUIDE

2009-2017 Dodge/RAM  
5.7L HEMI

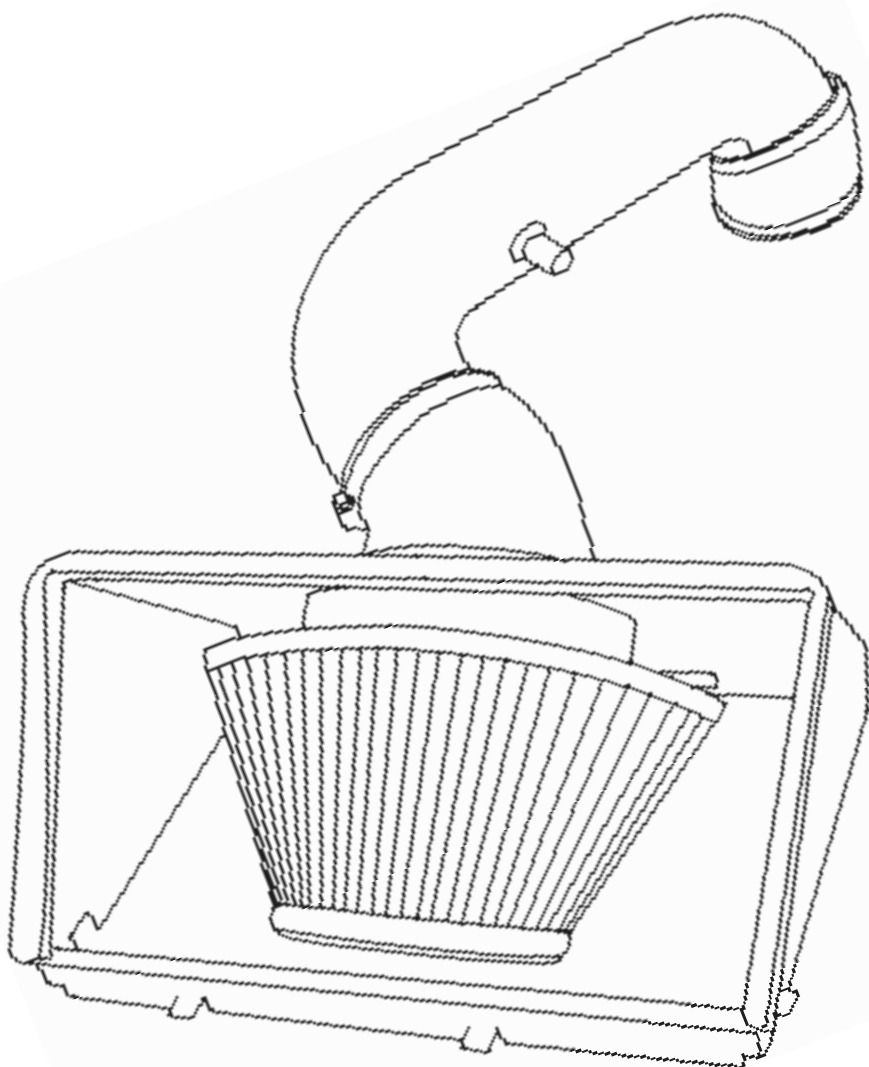

# TABLE OF CONTENTS

---

<b>3</b>	<b>GETTING STARTED</b>
3	PARTS LIST
<b>4</b>	<b>INSTALLATION INSTRUCTIONS</b>
4	REMOVING THE STOCK INTAKE ASSEMBLY
6	INSTALLING THE AIR FILTER
7	INSTALLING THE HOUSING
9	INSTALLING THE INTAKE TUBE
<b>10</b>	<b>WARRANTY</b>

# GETTING STARTED

## PARTS LIST

Item	Description	Qty
1	COUPLING, (3.5x2).....	1
2	GROMMET.....	1
3	INTAKE TUBE.....	1
4	CLAMP #056.....	3
5	COUPLING, ELBOW SILICONE.....	1
6	CLAMP #064.....	1
7	HEAT SHIELD.....	1
8	TRIM SEAL (29.25").....	1
9	AIR FILTER.....	1
10	ADAPTOR.....	1
11	BUTTON HEAD SCREW.....	5
12	HOSE (21"0).....	1
13	ELBOW 5/8.....	1
14	HOSE (4.5").....	1
15	FITTING (3/4x5/8).....	1

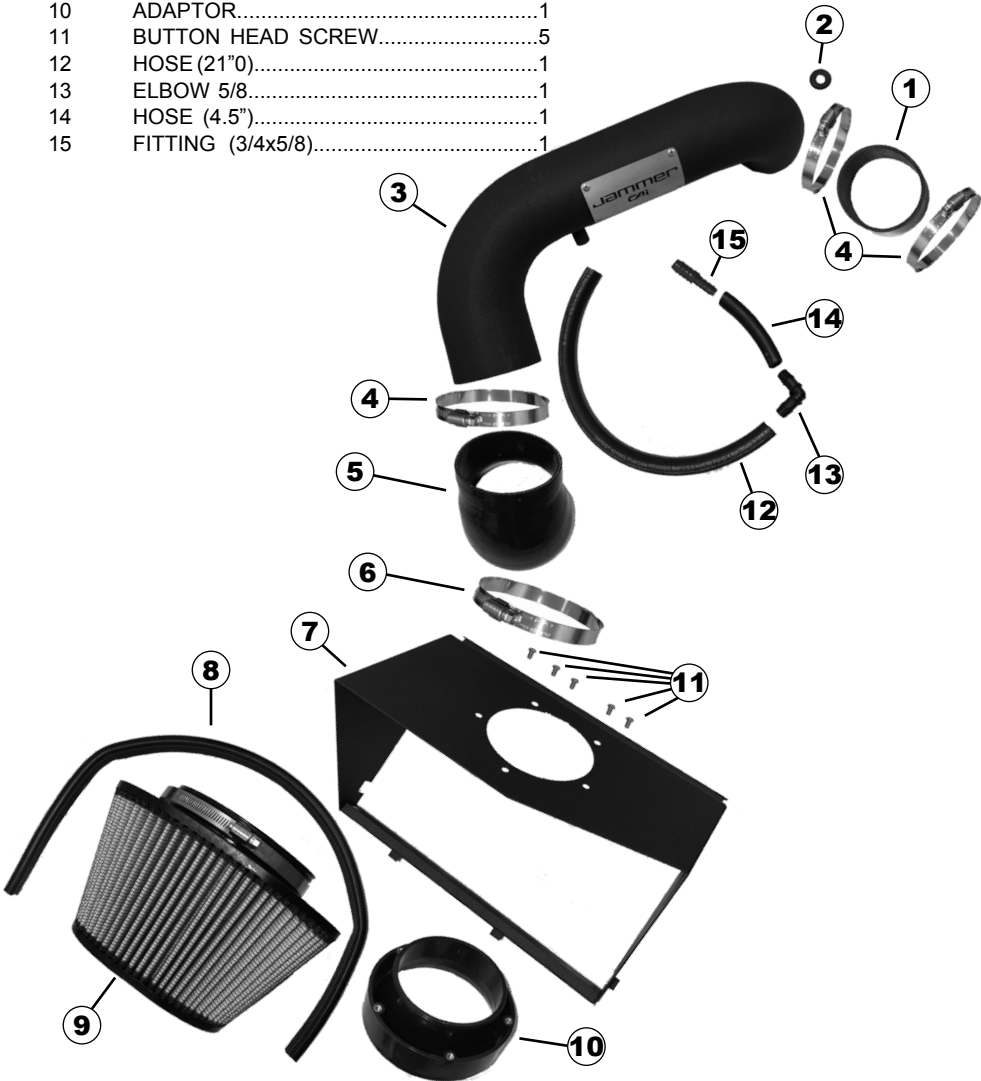

# INSTALLATION INSTRUCTIONS

## REMOVING THE STOCK INTAKE ASSEMBLY

*CAUTION: Disconnect the ground cable from the battery before installation.*

**STEP 1** - Remove the 4 clips holding the top portion of the air box together.

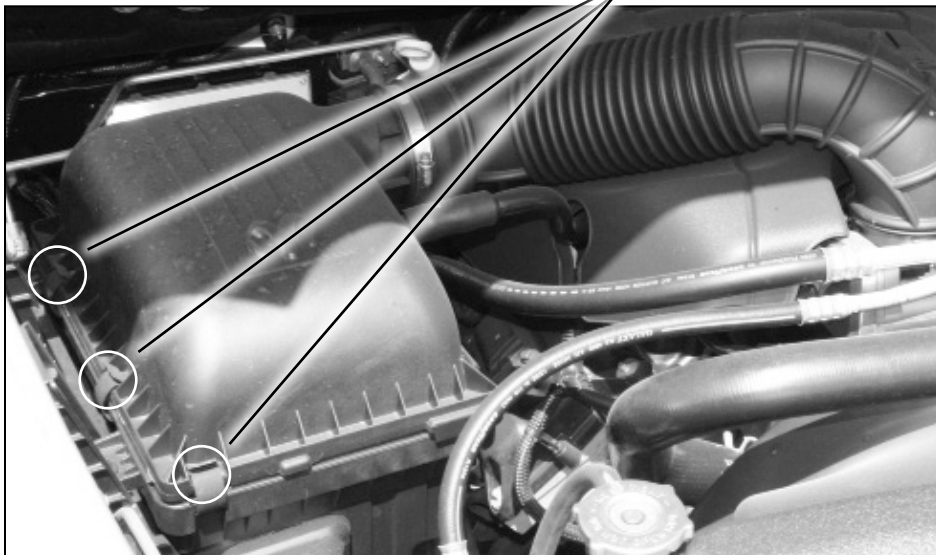

**STEP 2** - Disconnect the Temperature Sensor harness from factory intake.



**STEP 3** - Loosen the clamp holding the intake tube to the vehicle.

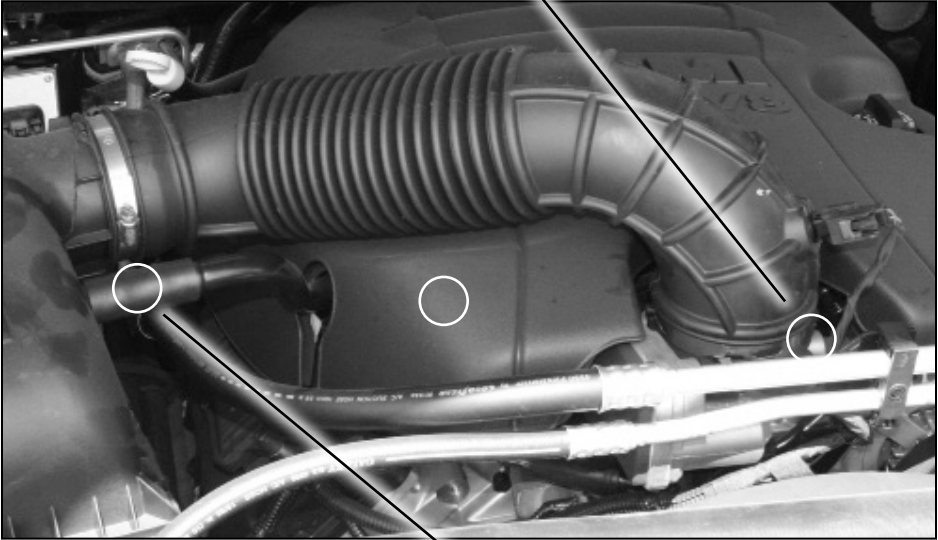

**STEP 4** - Disconnect the crank case line from the air box.

**STEP 5** - Pull the top of the intake system out of the vehicle with the intake tube.

**STEP 6** - Pull the engine cover off by lifting it straight up.

**STEP 7** - Now remove the stock crank case vent line from where it meets the engine, assemble the stock vent elbow with adaptor, long & short hose with elbow. Reinstall vent hose and engine cover.



## INSTALLING THE AIR FILTER

---

**STEP 8** - Using the hardware supplied, mount the adaptor to the heat shield using 5 button head screws.

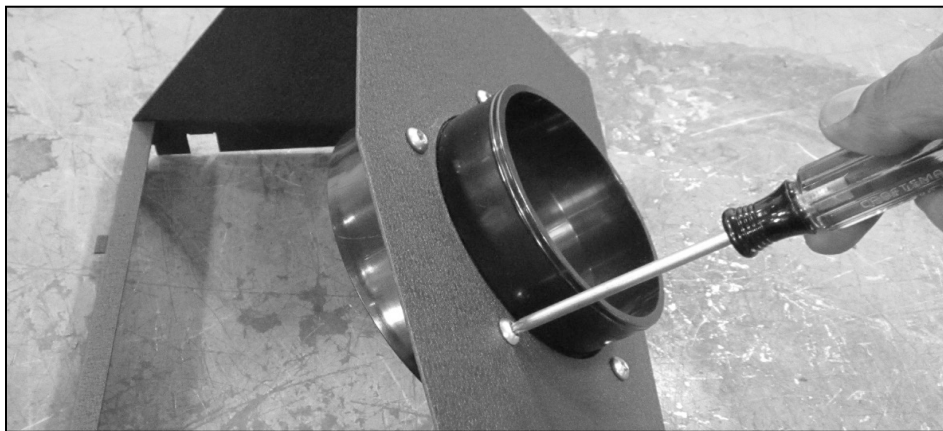

**STEP 9** - Mount your Jammer air filter to the adaptor installed in step 8 with the clamp provided

**STEP 10** - Now install the trim seal around the edge of the heat shield.



## INSTALLING THE HOUSING

**STEP 11** - Place the new heat shield and filter onto the lower half of the stock air box.

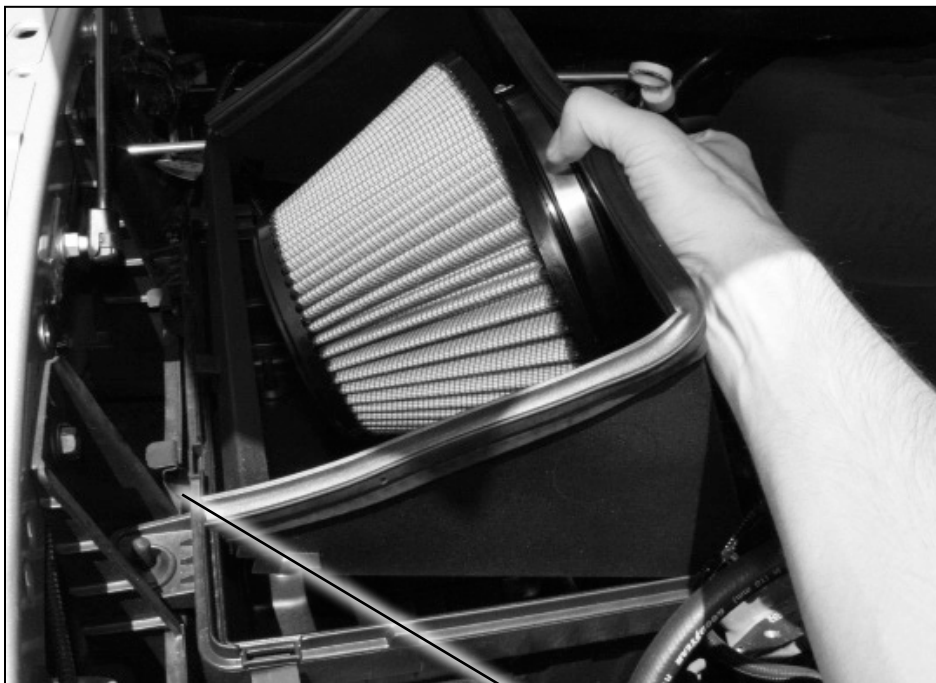

**STEP 12** - Use the factory clips to secure the heat shield down onto the air box.

**STEP 13** - Install the new grommet into your Jammer intake tube.

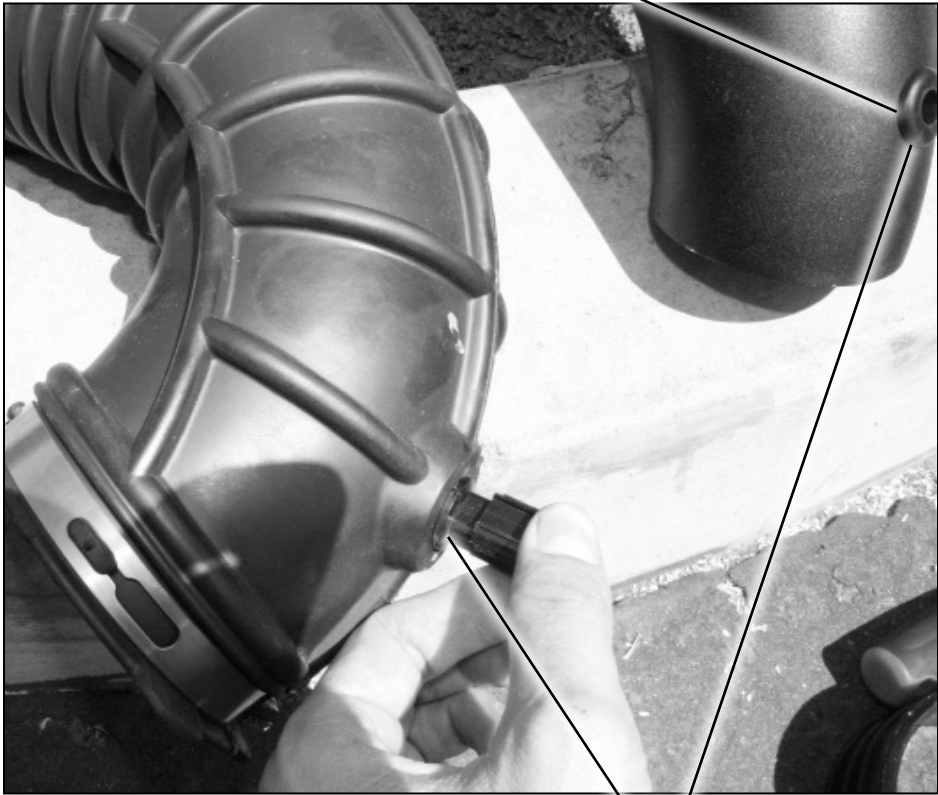

**STEP 14** - Carefully pull the temperature sensor out of the stock intake tube. Remove the O-Ring and insert it into the grommet on your Jammer intake tube.



## INSTALLING THE INTAKE TUBE

**STEP 15** - Install the intake tube filter end FIRST, then throttle body end.

**STEP 16** - Connect the crank case line that you installed in the step 7 to the intake tube.

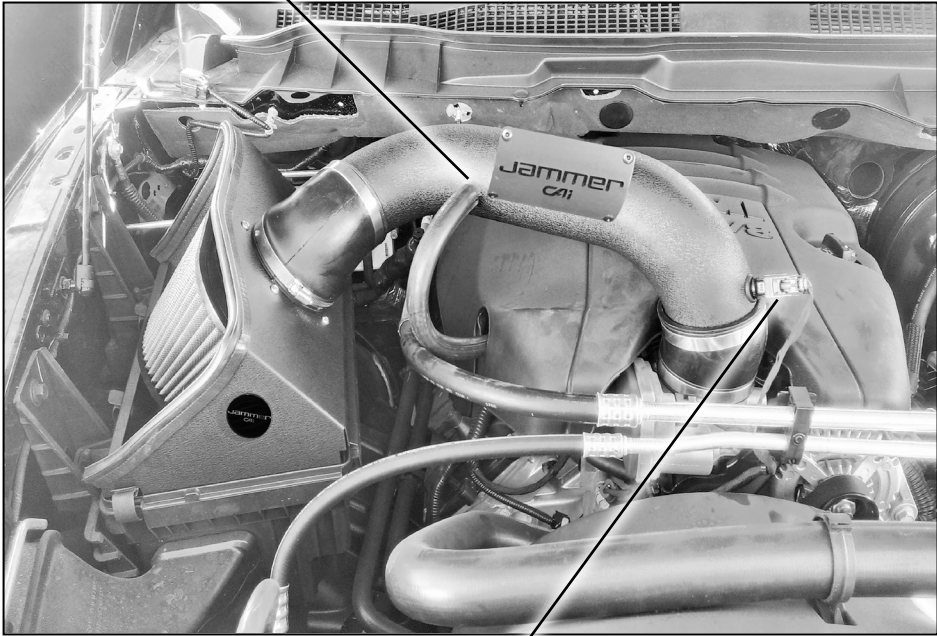

**STEP 17** - Connect the temperature sensor harness.

**STEP 18** - Your installation is now complete, check all connections to insure a proper seal.

***NOTE: Verify all connections are secure 100-200 miles after installation.***

# WARRANTY

---

Powerteq, LLC, (hereafter "SELLER"), subject to the conditions and limitations set forth herein, warrants to the original consumer purchaser only that each Jammer product sold by SELLER (the "Product") through an authorized dealer will be free from defects in material and workmanship under normal operating conditions for one (1) year after the date of purchase. SELLER will repair or replace, at SELLER's option, any Product that is found to be defective in material or workmanship under normal operating conditions during the one-year period after the date of purchase by the original consumer purchaser.

## **What Is Not Covered by This Warranty?**

This warranty does not apply to any of the following:

1. Loss, damage, repairs, or maintenance required as a result of accident, abuse, negligence, or misuse.
2. Loss, damage, repairs, or maintenance required as a result of any third-party tuning software.
3. Loss, damage, repairs, or maintenance required as a result of fire, water, hail, theft, earthquake, wind, ice, lightening, acts of god, accident, animals, corrosive atmosphere, or other external causes beyond the control of SELLER.
4. Any special, indirect, incidental, consequential, or punitive damages, including property damage, arising out of or related to the use or loss of use of the Product under this Limited Warranty.
5. Any Products purchased through auction websites.

## **Limitation of Liability**

The terms of this Limited Warranty constitute the entire agreement between the parties with respect to the Product. The original consumer purchaser's exclusive remedy shall be limited to the repair or replacement of the defective product. EXCLUDING THE LIMITED WARRANTY PROVIDED ABOVE, SELLER, TO THE MAXIMUM EXTENT PERMITTED BY LAW, MAKES NO WARRANTIES, EXPRESSED OR IMPLIED, AND DISCLAIMS ALL WARRANTIES, DUEITES AND CONDITIONS, WHETHER EXPRESS, IMPLIED, OR STATUTORY, WITH RESPECT TO THE WORK, INCLUDING WITHOUT LIMITATION ANY IMPLIED WARRANTIES OF MERCHANTABILITY OR FITNESS FOR A PARTICULAR PURPOSE. ANY REMEDY IS LIMITED TO THE PURCHASE PRICE OF THE PRODUCT.

---

### **How to Make a Warranty Claim**

Contact Powerteq Customer Service. BUYER will be required to submit proof of purchase from an authorized dealer within 5 days of the warranty claim.

THE INSTALLATION OF THIS PRODUCT INDICATES THAT THE BUYER HAS READ AND UNDERSTANDS THIS AGREEMENT AND ACCEPTS ITS TERMS AND CONDITIONS. IN THE EVENT THAT THE BUYER DOES NOT AGREE WITH THIS AGREEMENT, THE BUYER MAY PROMPTLY RETURN THIS PRODUCT, IN A NEW AND UNUSED CONDITION, WITH A DATED PROOF OF PURCHASE, TO THE PLACE OF PURCHASE WITHIN THIRTY (30) DAYS FROM DATE OF PURCHASE FOR A FULL REFUND.

**COPYRIGHT© 2017 REV 00**

*For additional questions not found in the user guide call:*

**Powerteq Technical Support: (855) 292-2121** 6:00 am - 5:00 pm MST

**To expedite your support call, please have your Vehicle Information,  
Part Number, and Serial Number ready prior to calling Technical Support.**